

**BRISTON ANTIQUE  
& COLLECTORS FAIR  
PAVILION LAYOUT**

Outside stalls are in the form of approx 8M x 4M pitches.

There is room for approx 500 pitches.

Position and layout of pitches has yet to be determined.

Casual pitches are available for people that turn up on the day. There will be an additional 20% extra to pay on top of the advance booking price.

Entrance to fair

Main Hall

Conference room

Bar

*Booking terms and conditions are available upon request. Copy provided upon receipt of booking fee, together with information pack*

Not to scale

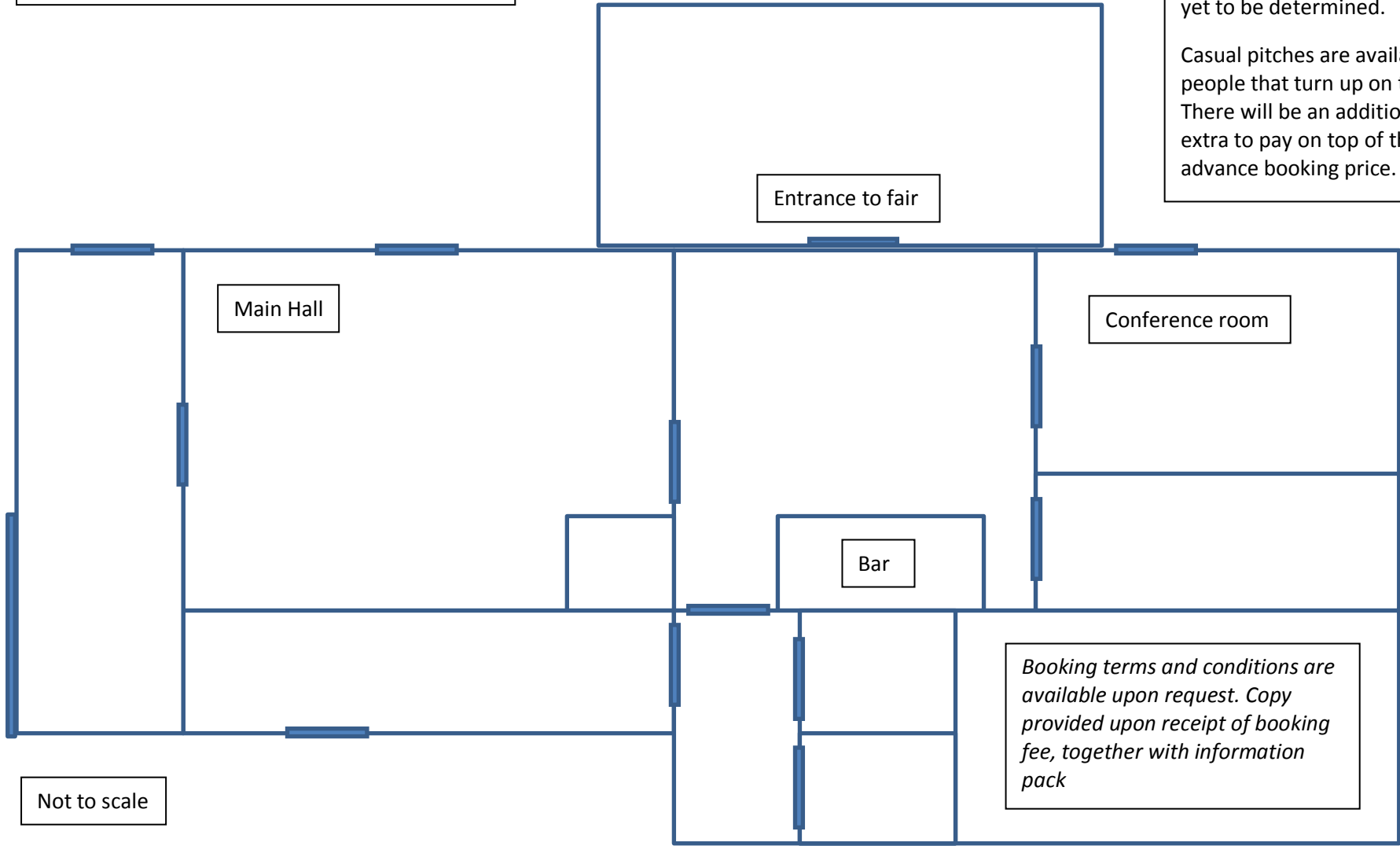

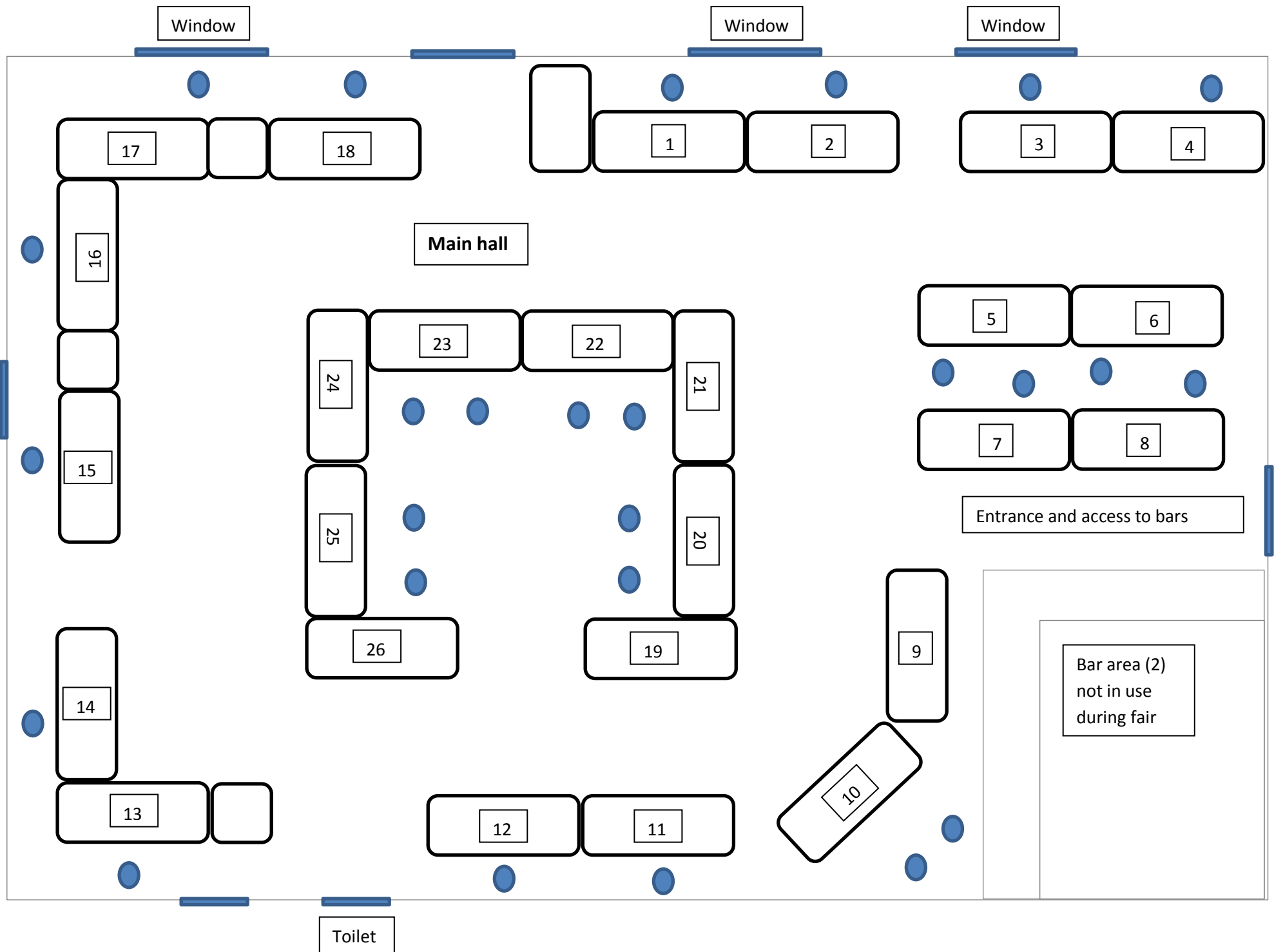

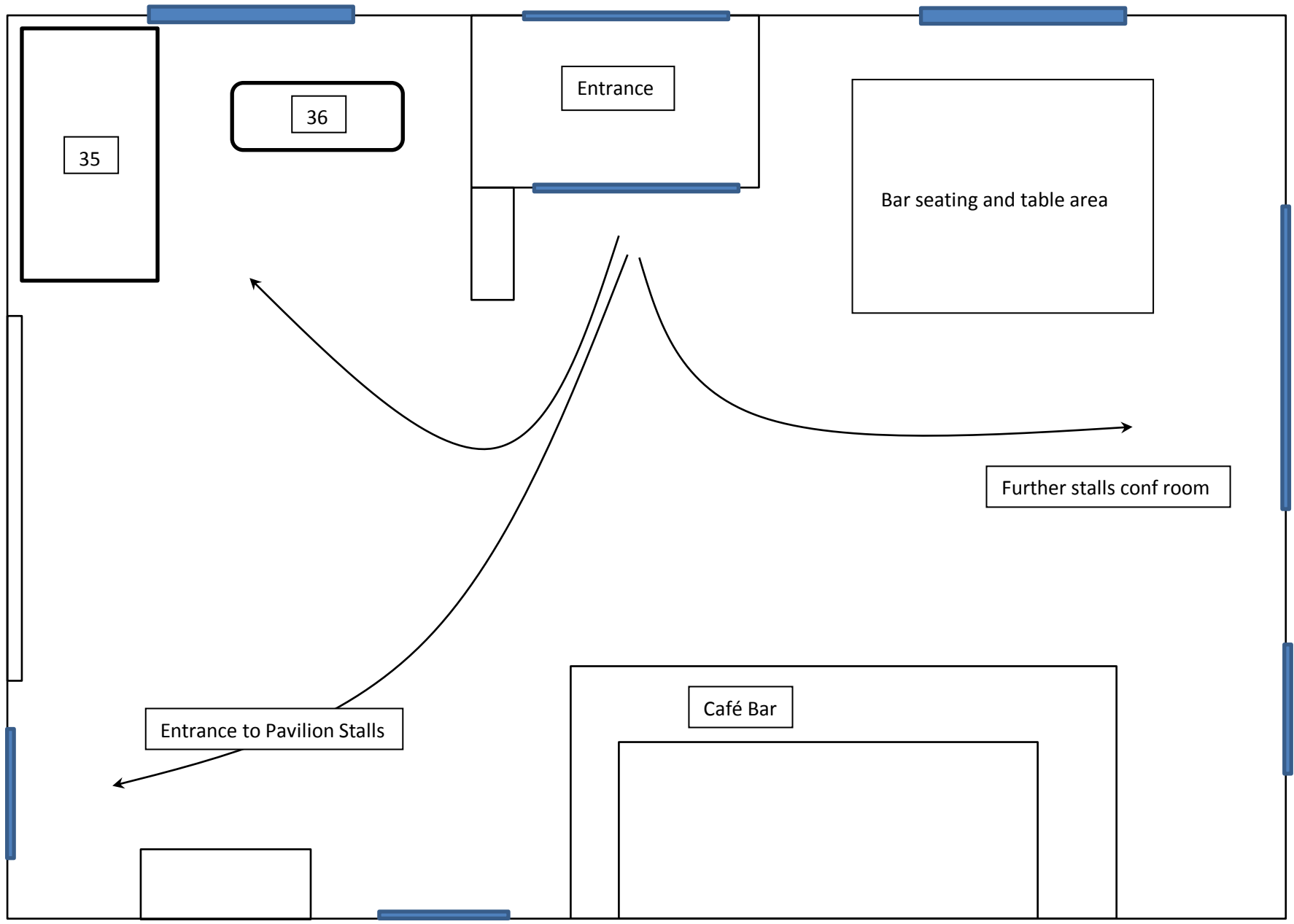

**BRISTON ANTIQUE  
& COLLECTORS FAIR  
PAVILION LAYOUT**

The table layout currently shown may be subject to change.

Entrance to conference room is via bi-fold doors which shall be open and accessed via bar area

Extra chairs will be available FOC

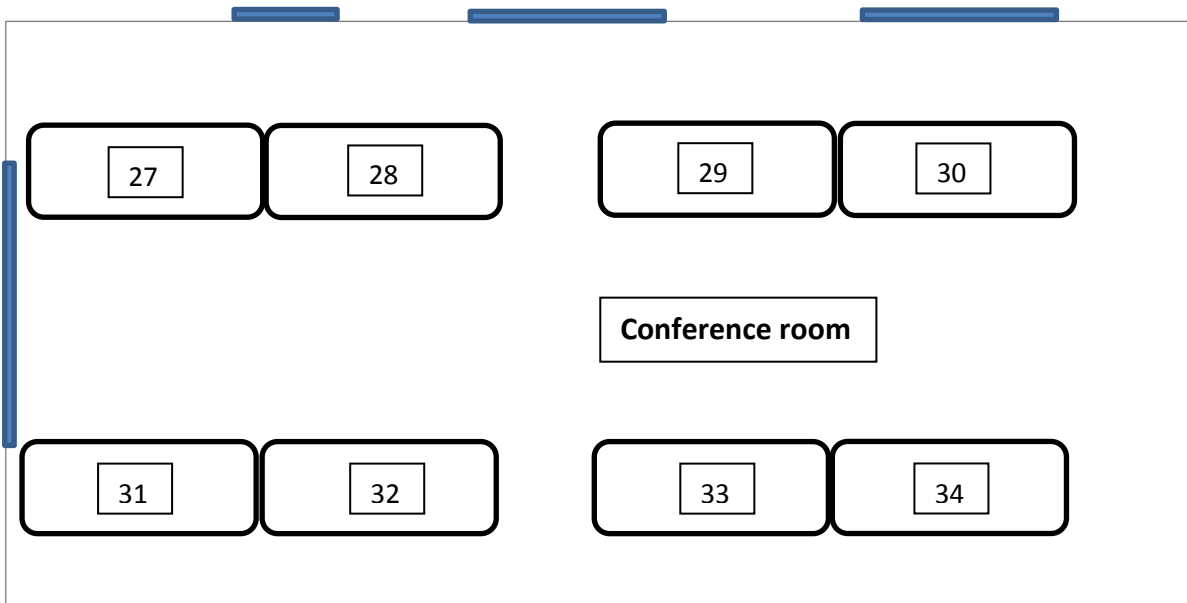

This will be our first fair in the Pavilion, the layout you currently see may be subject to change, but we have tried to maintain max manuevarability for the paying public without compromising safety and stall holder numbers.

The fair being held in August is in aid of the Briston Sport and Recreation Association (BSRA) Details of the BSRA can be found on the Bristonfairs website [www.bristonfairs.com](http://www.bristonfairs.com)

Please feel free to print out and post the flyers all are pdf printer friendly A4.

For booking please call 01263 861833/862559.

All tables £20.00 each, Doubles £35.00,

Outside pitches £20.00

There will be temporary parking available at the pavilion to enable stallholders to load and unload. After which we kindly invite you to park in the designated stallholder area parking